

Installation Guide

Supaflex Neonflex 0603



WARNING: Risk of electrical shock. Please read these instructions completely and carefully. Disconnect power before servicing or installing product.

- 1** Cut material to the length required using Novaneon Shears (cut only at the marked intervals on the underside of the casing).

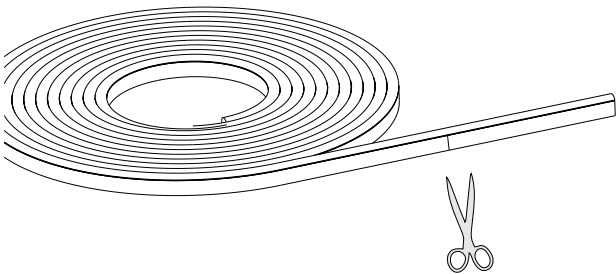

- 3** Solder the wire tails to the terminals for connection to power supply. Always ensure positive to positive and negative-negative connection.

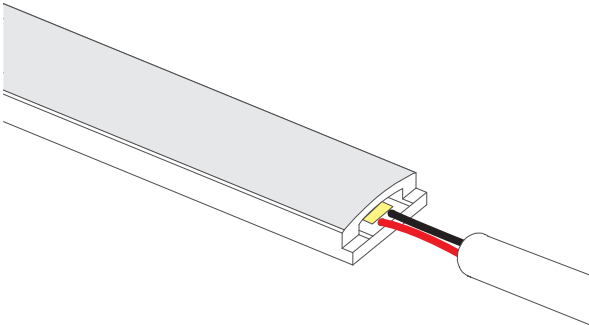

- 5** To seal terminating end, apply glue to the inside of the end cap and wipe off any excess glue.

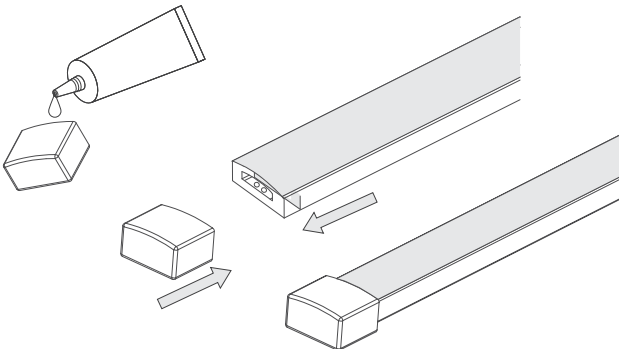

- 2** To connect to power, cut away a short section of the silicone casing to reveal the soldering pad.

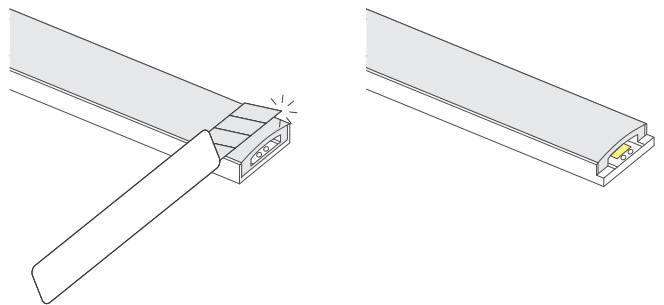

- 4** Seal the wired end: use the end cap with hole & thread the soldered wire tails through. Apply glue to the inside of the end cap, and push onto the LED strip, wiping off any excess glue. Wait for glue to dry before powering on.

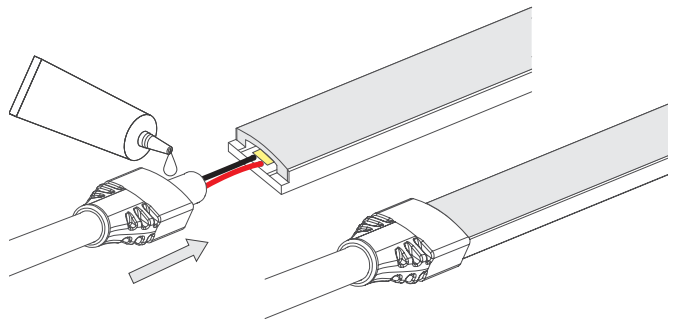

- 6** When handling the Neonflex, take care to only bend vertically and avoid twisting or stretching the strip, as this may damage the internal components.

