

# Installation Guide

## Spectrum RGB 24V



**WARNING:** Risk of electrical shock. Please read these instructions completely and carefully. Disconnect power before servicing or installing product.

- 1** Ensure the inside of your channel letter or sign box is clean and free of debris.

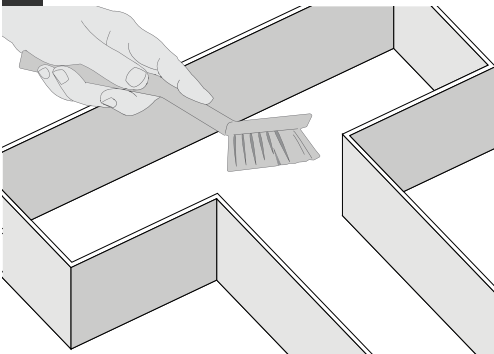

- 2** Remove tape from the rear side and stick LED modules in place using supplied LED layout.

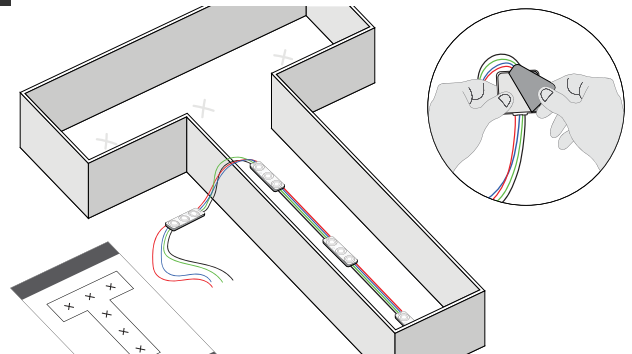

- 3** Wire up your modules using WAGO Splicing Connectors. Always ensure positive-positive, R-R, B-B and G-G connection. Do not exceed the maximum modules per series as this will result in voltage drop.

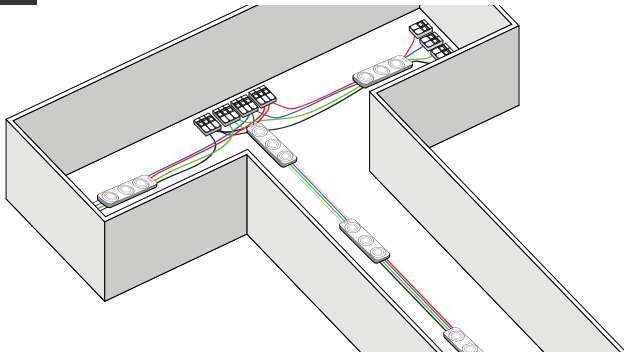

- 4** Secure LEDs by gluing modules in place

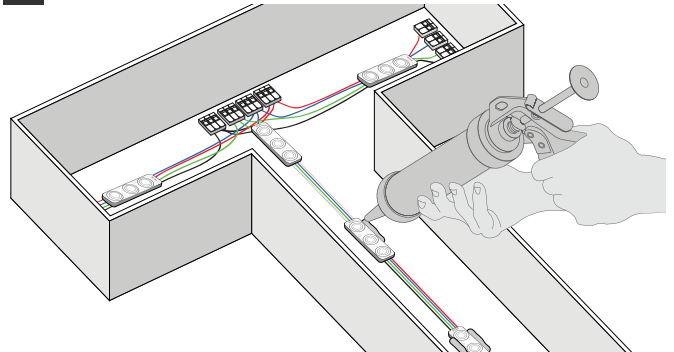

- 5** Drill holes out the back of the letters or sign box for connection to DC power supply

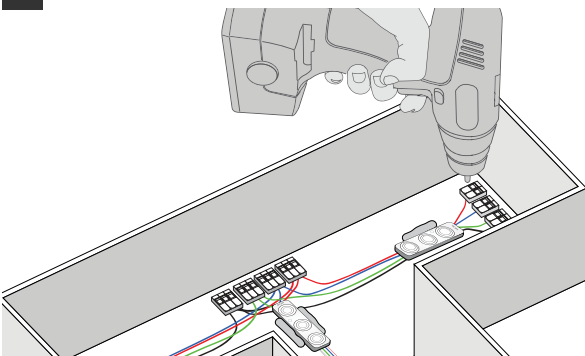

- 6** Connect the LED modules from the sign to the receiver and power supply. If there are multiple letters/signs, they should be connected in parallel to avoid voltage drop.

