

# Installation Guide

## Blaster 24V



**WARNING:** Risk of electrical shock. Please read these instructions completely and carefully. Disconnect power before servicing or installing product.

- 1 Ensure the inside of your channel letter or sign box is clean and free of debris. For best illumination ensure the inside of the box is white (matte finish preferred).

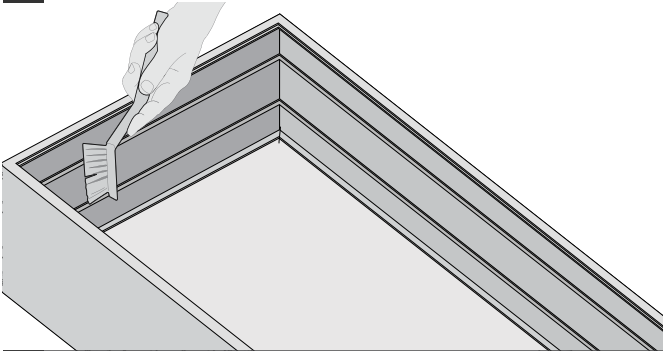

- 3 Secure LEDs by gluing modules in place.

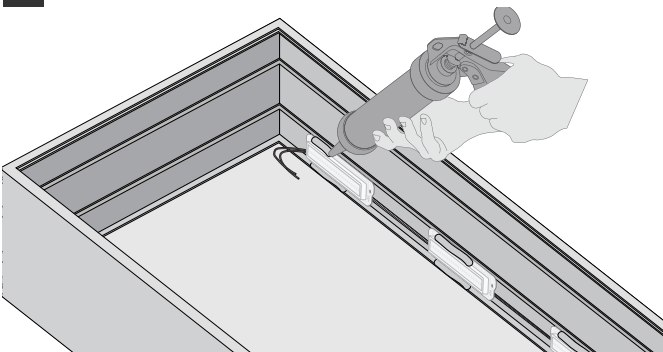

- 5 Connect modules from the sign to power supply, making sure to not exceed the maximum modules per series. Exceeding the maximum will lead to voltage drop and uneven illumination.

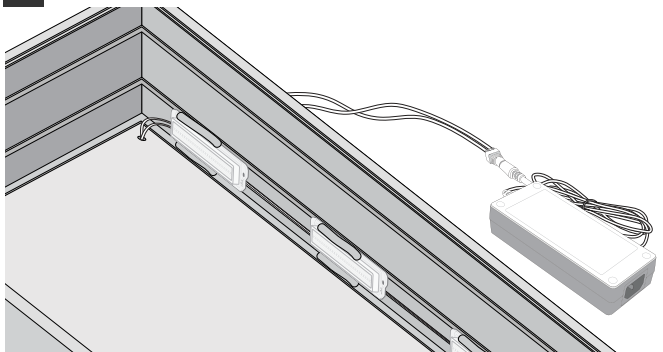

- 2 Using supplied LED layout, remove tape from module and press in place. For best illumination, install modules two-thirds of the way towards the back of the box for single-sided signs, centralised for double-sided signs.

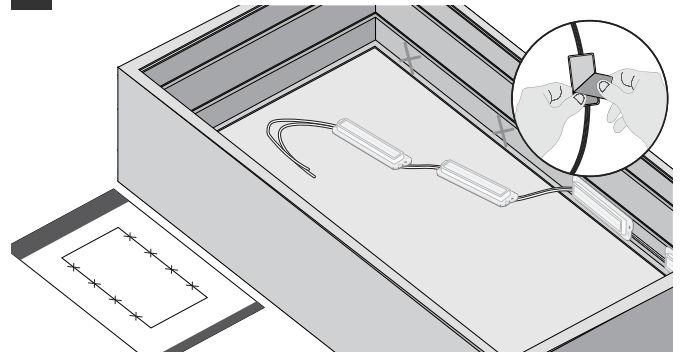

- 4 Drill a suitably sized hole out the back of the sign for connection to DC power supply.

